

Drenotex

Geodefence

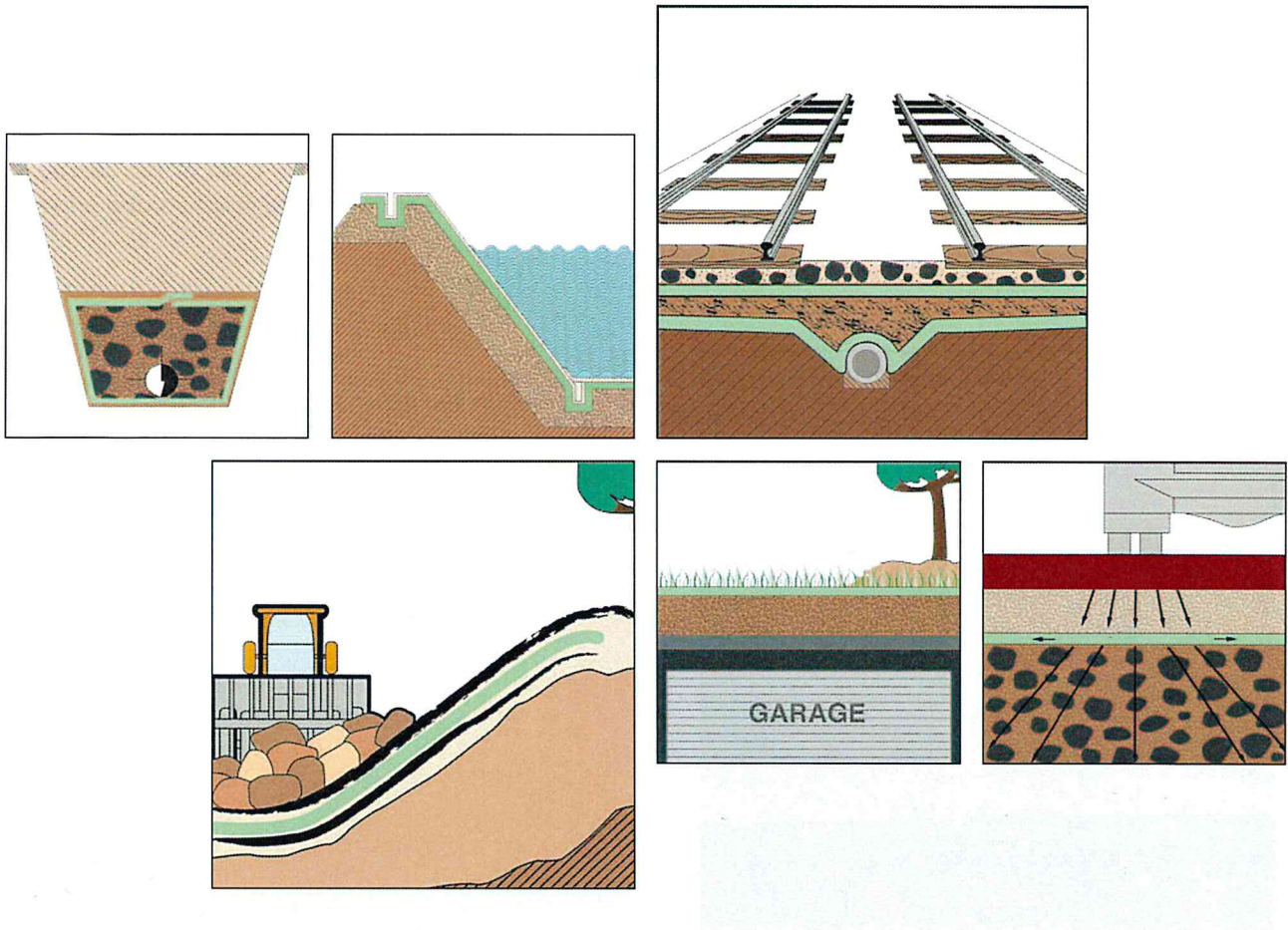

Polyester and polypropylene nonwovens for geotextile applications with (CE) marking

- rot-proof
- resistant to mould and rodents
- easy to lay
- resistant to UV rays



INTRODUCTION

Drenotex is used in civil and hydraulic engineering for protecting the ground from instability and ravelling. The application of **Drenotex** allows a proper redistribution of weights and contributes to avoid the contamination of the soil and to prevent the erosion caused by water infiltration.

REINFORCEMENT OF ROAD AND RAILWAY BEDS

Drenotex redistributes the mechanical stress, acting as anti-contaminant right at the base of the construction, which is generally the most critical point. **Drenotex** mitigates the pressure caused by the structure and prevent the ground from instability.

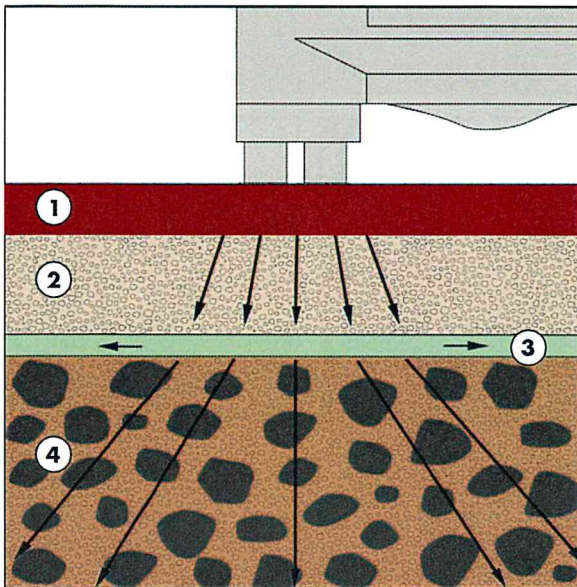

Fig 1.

1. Concrete or bituminous conglomerate
2. Rolled stabilized mix
3. **Drenotex**
4. Sub-base

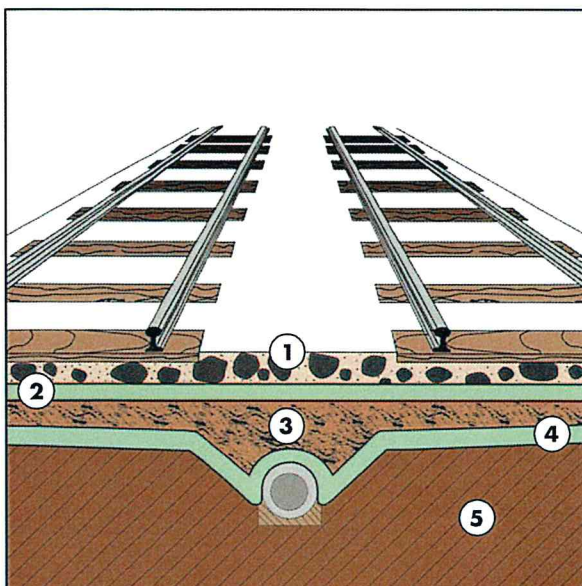
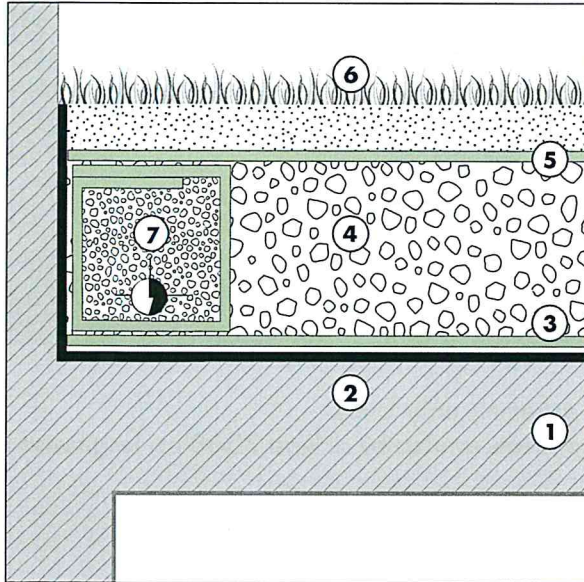

Fig 2.

1. Surface gravel layer
2. **Drenotex**
3. Gravel layer of a different gradation
4. **Drenotex**
5. Natural ground

CONSTRUCTION OF UNDERGROUND GARAGES AND ROOF GARDENS

Thanks to its mechanical properties **Drenotex** is the ideal solution for waterproofing roofs. Laid between the gravel layer and the soil, **Drenotex** can be used as an anti-contaminant and draining agent for roof gardens.



1. Floor slab
2. Waterproofing
3. **Drenotex** with mechanical protection function
4. Draining gravel layer
5. **Drenotex** with anti-contaminating and draining function
6. Ground and grass surface
7. Draining channel

SAFETY OF LANDFILL SITES

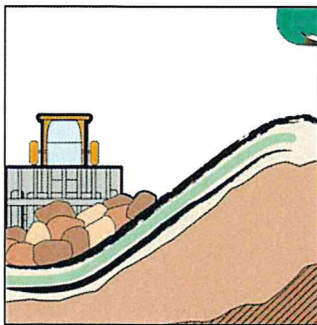

Drenotex applied as waterproofing support in the excavation reduces the risk of contamination.

Thanks to its mechanical properties **Drenotex** protects from cracks in the waterproofing layer, avoiding pollution of the ground.

REINFORCEMENT OF SLOPES AND HILLSIDES

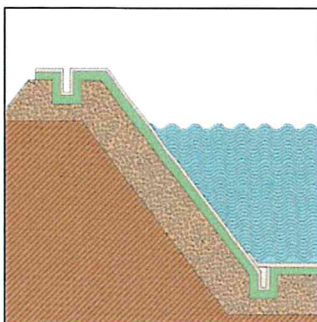

The water in excess can filter into the ground through the different layers of the soil, and it can undermine its compactness. **Drenotex** provides protection, by acting as a filter which prevents the detachment of pieces of soil.

LAYING INSTRUCTIONS



Despite its numerous and diverse applications **Drenotex** is extremely easy to lay. Lay the sheets and cover the whole area making sure that the sheets overlap by at least 20-30 cm lengthwise and 50 cm crosswise.